

LED/CFL OR HALOGEN 120V DIMMER

IMPORTANT INFORMATION

PLEASE READ BEFORE INSTALLING.

1. CAUTION: Use only on 120V lighting circuits. To avoid overheating and possible damage to other equipment, do not install to control receptacles, fluorescent light fixtures, motor-operated or transformer-supplied appliances. When used with LED or compact fluorescent light bulbs, make sure they are identified as "dimmable."
2. Use only with copper or copper-clad wire.
3. Install in accordance with all appropriate electrical codes and requirements.
4. It is normal for the dimmer to feel warm to the touch during operation.

MULTIGANG INSTALLATIONS

When more than one control is being installed ("ganged") in the same wall box, it might be necessary to remove all inner side sections prior to wiring for proper fit.

"Break-off fins" are the scored sections along each side of the mounting plate and are designed to be removed when "ganging". The fins are grooved to make their removal easy.

Remove desired INNER "break-off fins". Using pliers, bend side sections up & down until they break off. Repeat for each side section to be removed. Do not remove OUTER "break-off fins".

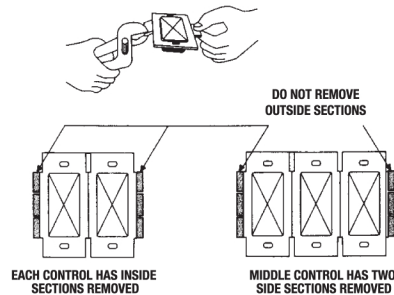

2 YEAR

WARRANTY

We warrant this product to be free from defects in material and workmanship.

Warranty obligations are limited to repairing or replacing all or any part of the product for 2 years from the original purchase date.

We are not responsible for any other loss or damage which may arise through use or installation of this product.

This warranty is void if damage is due to misuse, improper wiring or abuse.

INSTALLATION

ONLY A SCREWDRIVER IS NECESSARY.

- 1 **TURNING OFF POWER**
Disconnect power by removing fuse or turning circuit breaker to OFF position.
- 2 **REMOVING WALL PLATE AND SWITCH**
Remove wall plate and old switch. Carefully disconnect wires from switch.
- 3 **WIRING THE DIMMER**
For installations involving more than one control in a wall box, refer to the section above on "Multigang Installations" before beginning.

USING WIRE CONNECTORS PROVIDED, MAKE THE FOLLOWING CONNECTIONS:

FOR SINGLE-POLE DIMMER WIRING

Connect the **black** and **red** wires to the wires removed from the switch.

If there is no green or bare copper ground wire on the old switch, then for this type of installation, the **green** ground wire from the dimmer should be capped using a wire connector.

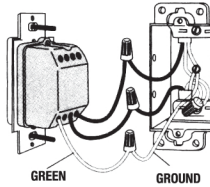

FOR 3-WAY DIMMER WIRING

Note: Only one dimmer can be used in a 3-Way circuit.

Connect the **black** dimmer wire to the wire removed from the darkest-coloured terminal screw on the switch.

Connect one of the **red** dimmer wires to either of the remaining wires removed from the switch.

Connect the remaining **red** dimmer wire to the remaining wire removed from the switch.

If there is no green or bare copper ground wire on the old switch, then for this type of installation, the **green** ground wire from the dimmer should be capped using a wire connector.

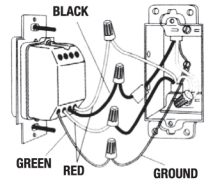

FOR COMBINATION SINGLE POLE AND 3-WAY MODELS

For a single pole application, **do not** use the RED dimmer lead which has label affixed to it. **Note:** If label is not affixed to one of the RED leads, use a small wire connector to cap off.

Using the remaining BLACK and RED leads, follow instructions "FOR SINGLE-POLE DIMMER WIRING".

For three way application, be sure to remove label affixed to the RED dimmer lead then follow instructions "FOR 3-WAY DIMMER WIRING".

4 MOUNTING DIMMER

Fold wires carefully into the wall box and mount dimmer with screws.

5 TURN ON POWER

Switch circuit breaker back ON or re-install fuse.

6 LED DIMMER TRIM ADJUSTMENT

Trim adjustment is used to compensate for bulb flicker or bulbs not lighting by adjusting the minimum dimming range.

Adjusting Dimming Range:

- To ensure full dimming range, rotate trim wheel or lever down (depending on model) until it stops.
- For LED and compact fluorescent light bulbs, turn on dimmer and dim to lowest setting. If bulbs flicker or do not turn on, adjust trim upwards until bulbs turn on or do not flicker.
- Turn dimmer off then on and check the dimming levels to verify everything is functioning properly. (Adjust as necessary)
- Once everything is working normally, install wall plate.